

! Tools required:

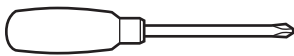

! Do not throw away packaging materials until assembly is complete.

! Assemble this item on a soft surface, such as cardboard or carpet, to protect finish.

! Proper assembly of this item requires 2 people.

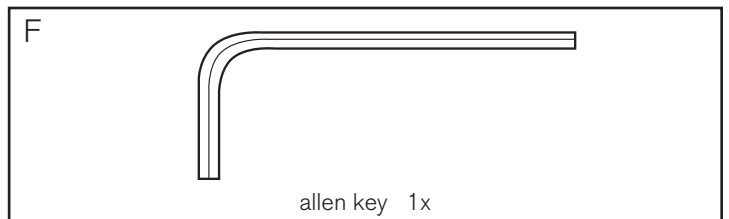
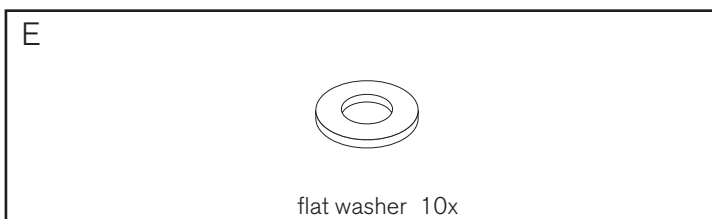
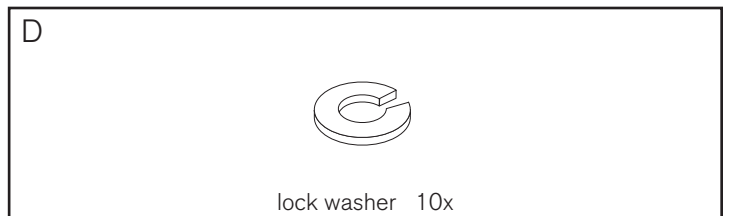
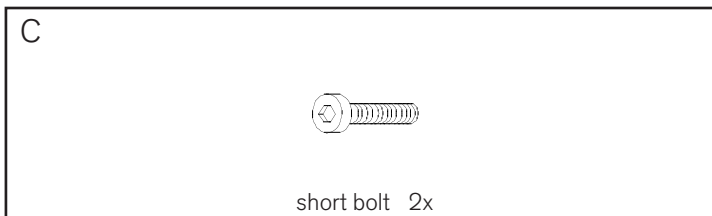
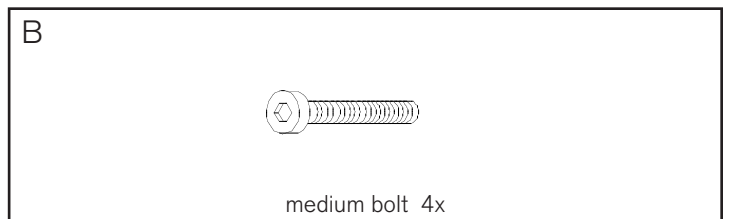
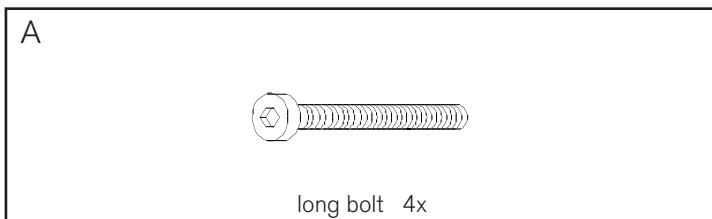

1. Fasten seat to back using long bolts (A), short bolts (C), lock washers (D), and flat washers(E) as shown. Tighten bolts using allen key (F).

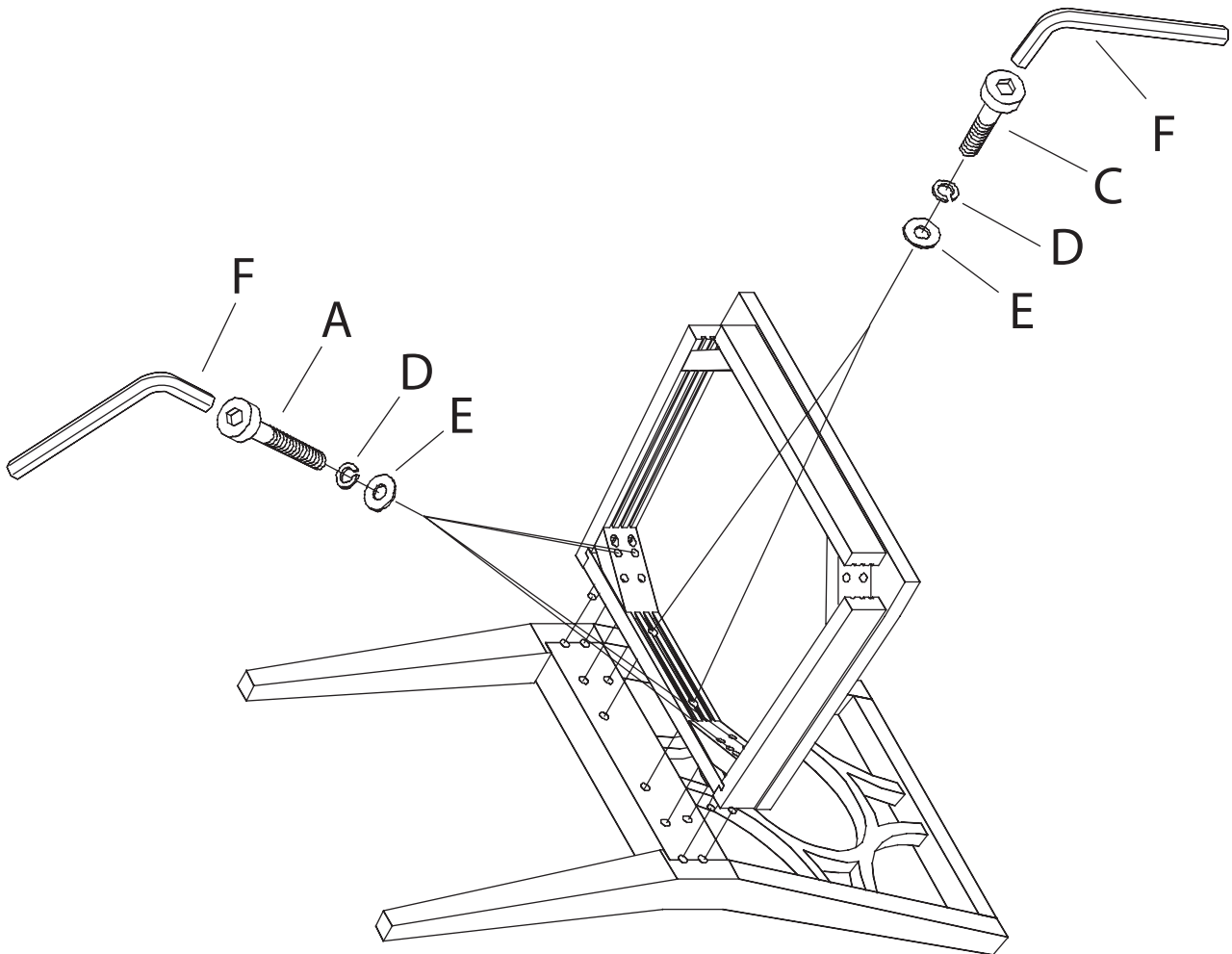

2. Fasten front legs to seat using long bolts (A), medium bolts (B), lock washers (D), and flat washers (E) as shown. Tighten bolts using allen key (F).

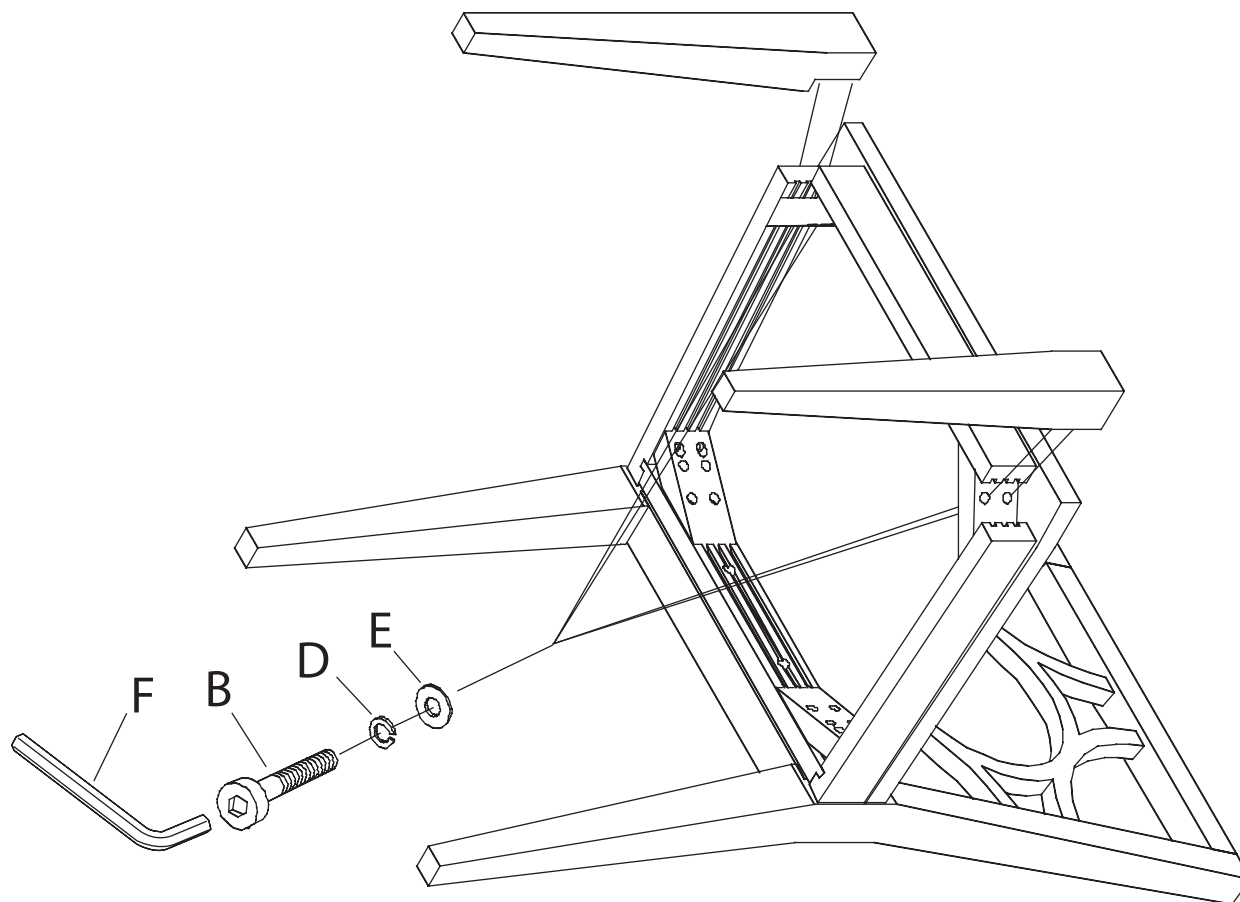

#### CARE INSTRUCTION

Hardware may loosen over time. Periodically check that all connections are tight.

Wipe with a soft, dry cloth. To protect finish, avoid the use of chemicals and household cleaners.